

(A) CROSS SECTION

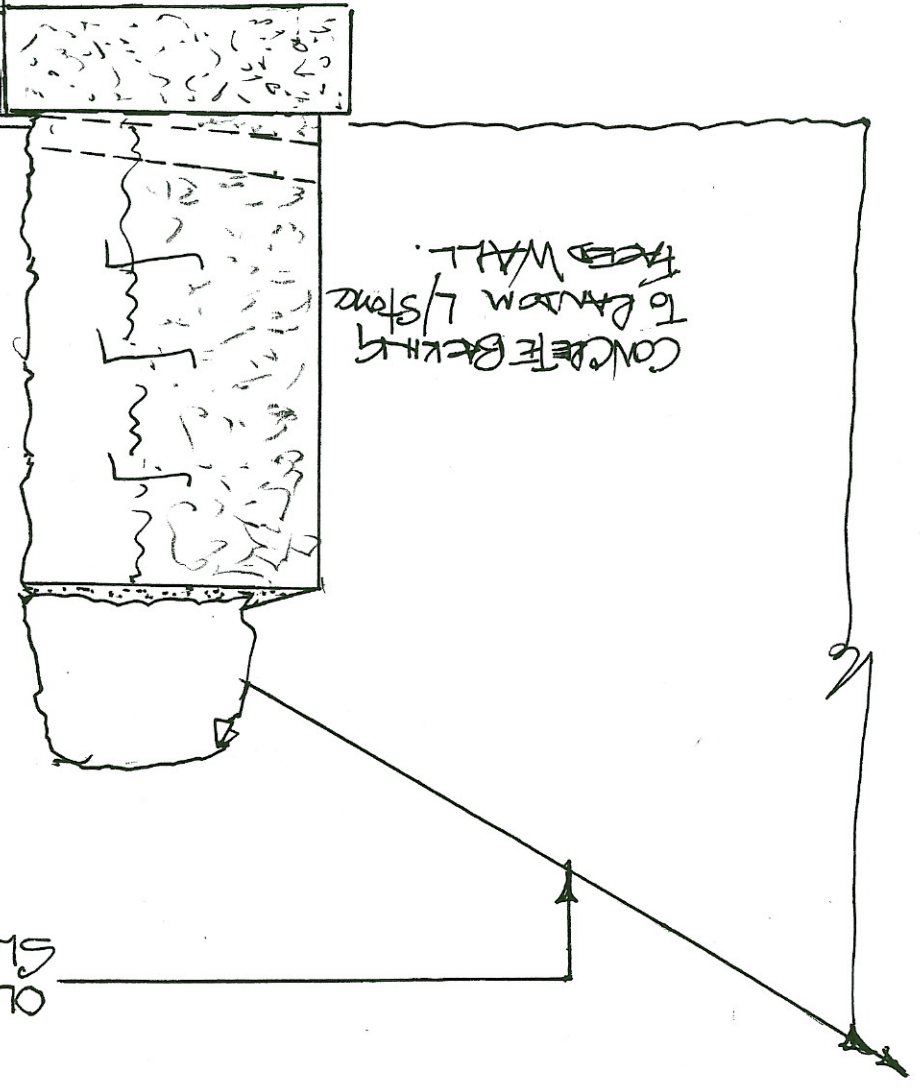

(B) EAST ELEVATION

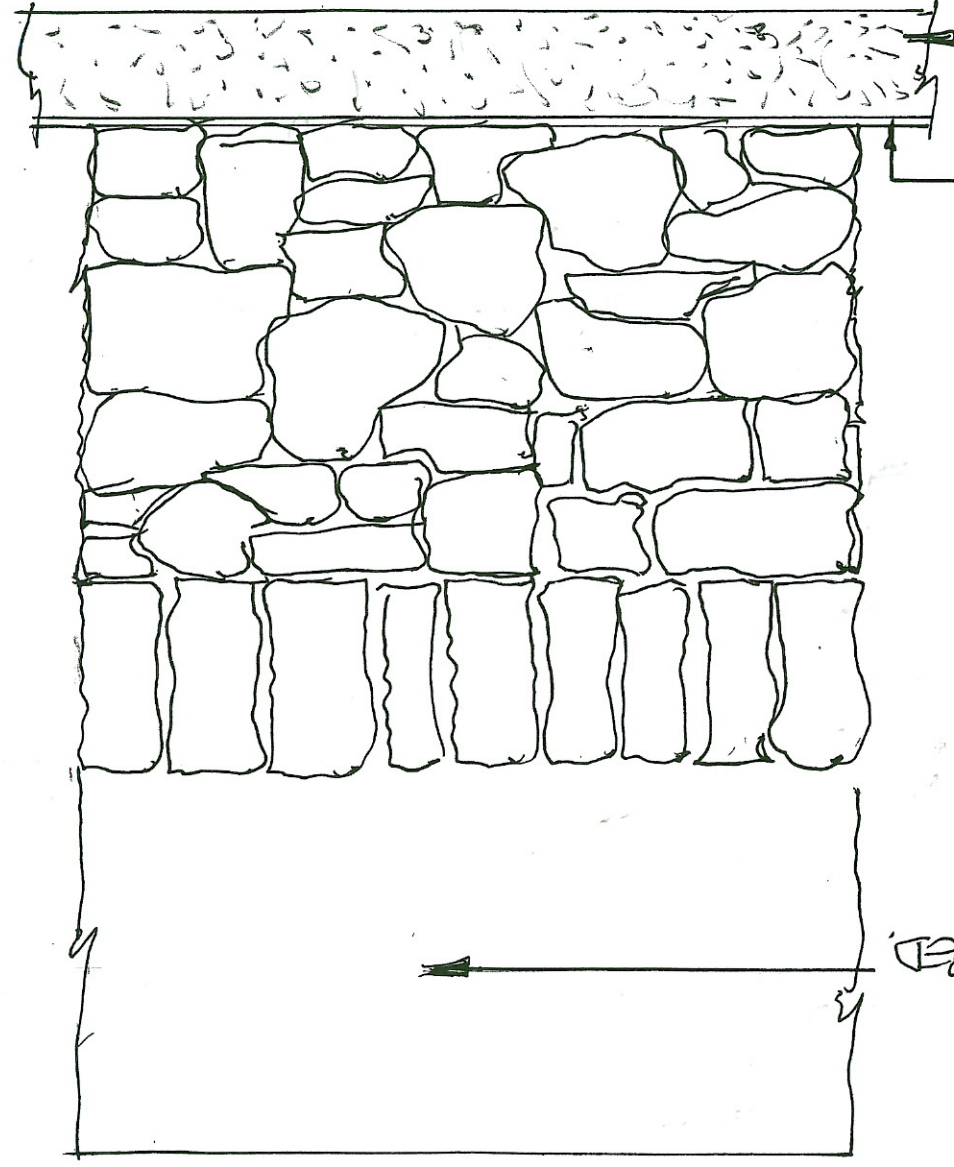

OLD TENNIS COURT EXCAVATED TO FORM  
SLOPE TO BE SOILED/SEED/LANDSCAPED.

Height to retaining excavation of  
the old tennis court - Approx 300mm  
(- see above note)

Survival to o/s of MUSA fence  
(see above note)

Foundations

Notes:-

- Final height of the wall subject to ground conditions upon completion of the excavation of the redundant tennis court
- Random limestone faced support wall backed with concrete giving dry stone wall appearance to match existing e/s wall around recreation ground. Limestone copings to be bedding and mortared pint finish.